



ASR BIKE FRAME PROTECTION KIT PLACEMENT INSTRUCTIONS

BIKE FRAME PROTECTION KIT PLACEMENT INSTRUCTIONS

WHAT YOU'LL NEED TO GET STARTED

- Lint free rag
- Spray bottle with soap
- Hair dryer / heat gun
- Clean bike
- Clean hands
- Measuring device

INSTRUCTIONS

1. Clean bike thoroughly with mild soap and water prior to decal application. It is best if you can apply decals on a new frame.
2. Wash hands before application or wear a pair of nitrile/latex gloves to keep any dirt from sticking to the decal.
3. Get a spray bottle full of water. Add a drop or two of soap to help the decals slide around if needed.
4. Working with one decal at a time, spray the appropriate area of the frame and adhesive-side of the decal.
5. Place decal in the locations provided below, re-placing or sliding decal as needed.
6. Once the decal is in the right spot, use the provided squeegee to start flattening the decal onto the frame. Start in the middle, working along the middle length. Gradually squeeze out the water toward the edges, working thoroughly and patiently to remove ALL water under the decal.
7. Use a clean cloth or towel to help lay the decal flat and wipe off excess water. At this point, some edges of the decals might not be perfectly flat on the frame.
8. Using a heat gun or hairdryer on low setting, apply heat to the decal edges for 2-3 seconds at a time. Using a clean rag or squeegee, work on any edges or bumps to lay them flush to the frame. Re-apply heat and repeat as necessary.
9. When it's time to remove or replace your protective decals, use a heat gun to warm up adhesive and pull back decal slowly. Do not remove without warming up decal adhesive first. Clean off any residual adhesive with mild soap and water.

NOTE:

Feel free to cut out any custom shapes you might want using the remaining decal scraps. Get creative!

DECALS

BOTTOM BRACKET

XS / S M / L / XL



DOWNTUBE + XL



TOP TUBE



SEATTUBE + XL/XXL



CHAINSTAY - INNER LEFT/RIGHT



RIGHT SEATSTAY/CHAINSTAY - OUTER



LEFT SEATSTAY/CHAINSTAY - OUTER



INNER SEATSTAY



CHAINSTAY BRIDGE



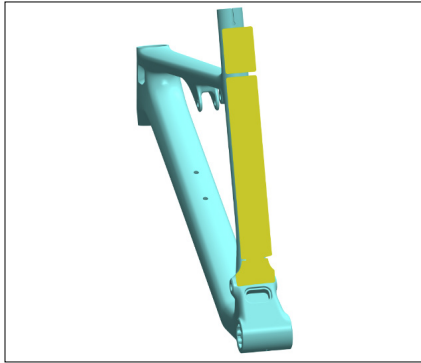

SEAT TUBE

Bottom of protector should sit just above the rear routing hole, and the top of the protector should be centered on the back of the seat tube.

Place extension protector directly on top of main protector for L and XL.

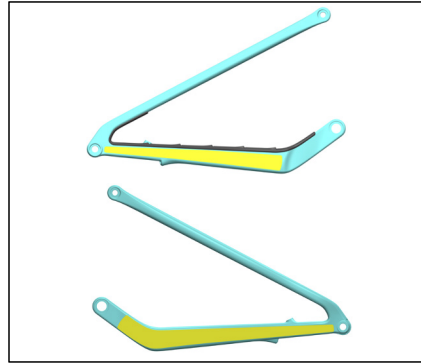

OUTER CHAINSTAY

Center decal on chainstay height. Drive side protector to sit just behind chain ring cutout. Align the bend in the non drive side protector with the bend in the chainstays.

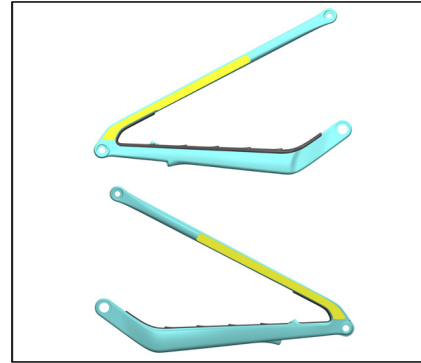

OUTER SEATSTAY

Center protectors on seat stay height. Line up protector bend with seat stay bend.

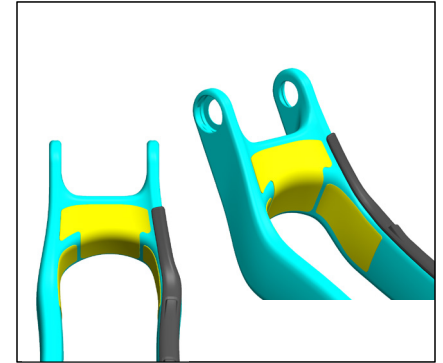

INNER CHAINSTAY & BRIDGE

Place bridge protector on bottom edge of chain stay bridge, centered on the bridge. Then place left and right protectors next to bridge protector, centered on chainstay height.

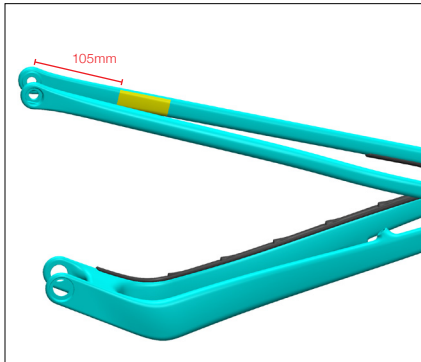

INNER SEATSTAY

Center protectors on seat stay height. Front edge of protector should be 105mm behind center of seat stay pivot.

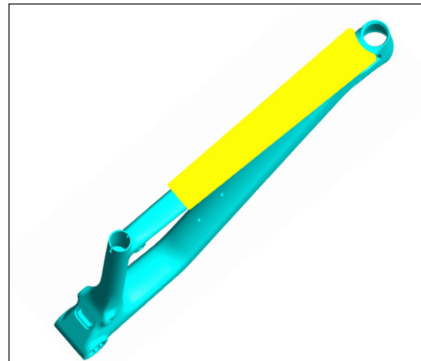

TOP TUBE

Center protector on top tube. Leading edge of protector should be 5mm behind head tube flat surfaces.

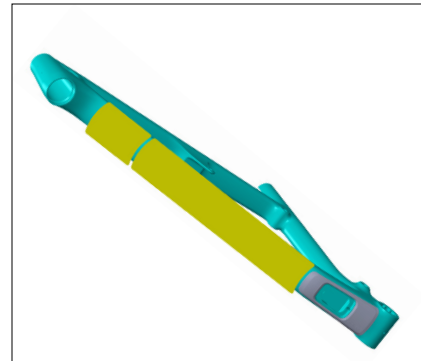

DOWNTUBE

Center decal on downtube. Rear edge of protector should be just ahead of rubber protector.

Install extension decal just above main decal for L and XL.

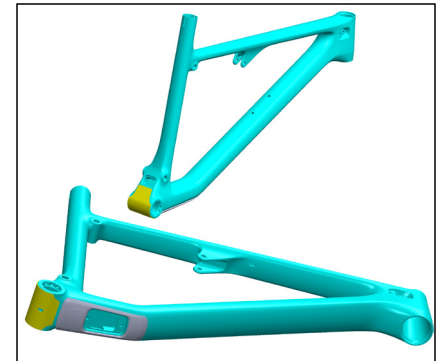

BOTTOM BRACKET

Make sure to use correct decal (XS/S or M/L/XL). Center decal on bottom bracket, making sure drain hole is exposed by decal hole. Leading edge of decal should be just behind rubber guard. Rear edge of decal should be just below routing hole (size S decal will be about 10mm below hole, others will be much closer).

Suggest removing rear triangle to install.